



Distribution Valve Lite Stem Disc

The K-Rain 4000 Hydrotek distribution valves supplied by PPI have an indexing mechanism that ensures water is sequentially directed to a series of outlets. The mechanism requires a minimum water flow rate through the valve to compress a spring-loaded cam follower. In some circumstances where water flow through the valve is insufficient, the spring does not compress and this prevents the valve from indexing from outlet to outlet.

The flow rate required to operate the standard valve mechanism is between 40 and 150Lpm for the four-outlet valve and between 40 and 95Lpm for the six-outlet model.

There are a number of possible causes for the insufficient flow rate, the most common being the use of an upsized sullage pump, which cannot overcome distribution pipe friction or topographical head pressures.

In instances where the flow rate produced by the sullage pump is between 22 and 40Lpm, an optional Lite Stem Disc assembly is available for retrofitting into the K-Rain valve that allows it to work as designed.

The Lite Stem Disc is identified by a Blue spring plunger on the underside of its rubber disc.

Replacing a standard (white) stem disc assembly with a Lite Stem Disc assembly is a relatively straightforward task that takes around five minutes to complete.

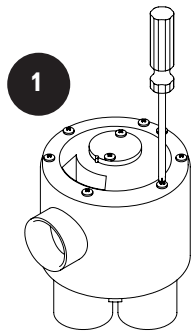

Step One:

With a Phillips Head screwdriver remove the screws around the perimeter of the valve cover. Do not remove the two screws that secure the cam to the cover.

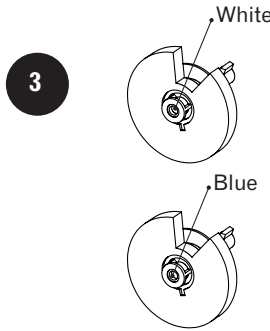

Step Three:

Confirm the spring rating of the Lite Stem Disc by identifying the blue spring plunger on the underside of the rubber disc.

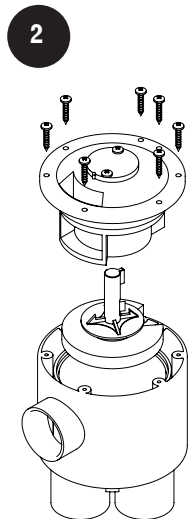

Step Two:

Gently pry off the cover and lift out the Standard Stem Disc from the valve body. Take care not to lose the o-ring seal.

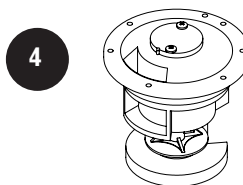

Step Four:

Insert the Lite Stem Disc into the cover, ensuring the stem locates fully into the black cam.

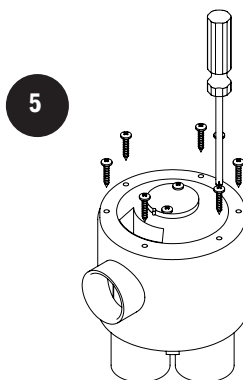

Step Five:

Hold the disc assembly and cover together and carefully locate them in the valve body. The cover screws ensure it is located in the correct position. Replace and tighten the cover screws with a Phillips Head screwdriver.

Description	EAN 9314212 +	PPI Code	Ord Qty	List Price
Distribution Valve – Lite Stem Disc	065322	MT/DV7005509	1	\$57.95

AUSTRALIA – PPI Corporation Pty Ltd (ABN 79 010 656 005)
QLD Sales Office Ph: (07) 3865 2300 Fax: (07) 3857 0058
Townsville Sales Office Ph: (07) 4779 7322 Fax: (07) 4779 2509
NSW Sales Office Ph: (02) 8706 2400 Fax: (02) 8706 2499
VIC Sales Office Ph: (03) 9791 3700 Fax: (03) 9791 3900
SA Sales Office Ph: (08) 8447 2611 Fax: (08) 8447 8117
TAS Sales Office Ph: (03) 6248 5933 Fax: (03) 6248 5988
WA Sales Office Ph: (08) 9212 3200 Fax: (08) 9355 0675
NT Agent Territory Hardware Ph: (08) 8947 1250 Fax: (08) 8984 4461

EXPORT ENQUIRIES Ph: +61 7 3865 3699 Fax: +61 7 3857 0058

NEW ZEALAND – PPI Corporation (NZ) Limited
Christchurch Ph: (03) 313 7956 Fax: (03) 313 5551

EMAIL: sales@ppi.com.au
WEB: www.ppi.com.au

Date: 30th June 2006